



HDMI Extender Set, Full HD, 50 m



Quick Installation Guide
DS-55100-1 Rev.3

Table of Contents

1. Introduction	3
2. Product Features	3
3. Package Content.....	4
4. Specification	4
5. Penal Description.....	4
6. Connection.....	6
7. Installation Requirements	6
8. EDID Setting	6

1. Introduction

The Digitus HDMI Extender Set, Full HD offers an extender solution of up to 50 m for the highest demands. It is used to transmit digital video and audio signals to a maximum length of up to 50 m. The highest supported video resolution is 1080p / 60Hz. The transmitter unit features an EDID switch, which can be used to regulate resolution and audio format of the output signal. The transmitter also has an HDMI Loop Out Port, which allows you to connect a local monitor. Thanks to PoC (Power over Cable) support, it is only the transmitter unit that needs to be powered. The package includes two bidirectional infrared units (transmitter, receiver), which can be used for the remote control of the connected input source.

2. Product Features

- Extends the maximum length for HDMI cable to up to 50 m via a simple network cable
- Highest supported video resolution: 1080p / 60 Hz
- Supports CAT 6, CAT 6A, CAT 7 network cables
- EDID Switch - Allows you to set resolution and audio format on the transmitter unit
- HDMI Loop Out - Allows you to connect a local monitor to the transmitter unit
- Supports PoE (Power over Ethernet) - thus no power supply is required for the receiver unit
- Supports uncompressed audio signals such as LPCM
- Compact size, simple use and installation

3. Package Content

- 1x HDMI Extender transmitter unit
- 1x HDMI Extender receiver unit
- 1x Power supply unit: DC 5V/2A
- 1x IR transmitter unit
- 1x IR receiver unit
- 1x Instruction manual

4. Specification

Support	HDCP 1.2a
Bandwidth	4.95 Gbps
Color depth	8 bits
Housing	Metal casing
Power supply unit	DC 5V/2A
Dimensions (1x unit)	L 7.2 x W 6.70 x H 2.3 cm
Color	black

5. Penal Description

Transmitter unit (TX)

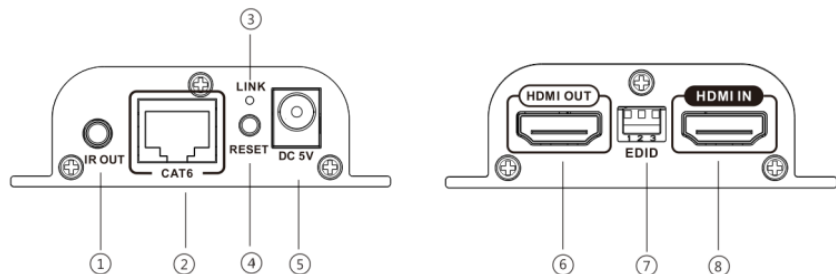

- ① IR signal output to connect with blaster extension cable
- ② RJ45 signal output

- ③ HDMI signal indicator led: it lights on all the time when HDMI signal input, flashes when no signal input
- ④ Reset button
- ⑤ DC 5V power input
- ⑥ HDMI signal output
- ⑦ EDID switch
- ⑧ HDMI signal input

Receiver unit (RX)

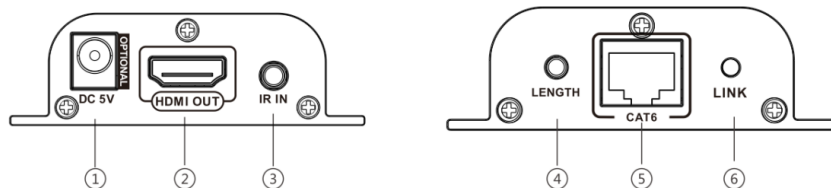

- ① DC 5V power input
- ② HDMI signal output
- ③ IR signal input to connect with IR receiver extension cable
- ④ LENGTH: for adjusting to the length of network cable
- ⑤ RJ45 signal input
- ⑥ RJ45 indicator led: it lights on all the time when HDMI signal transmission, flashes when no signal transmission

6. Connection

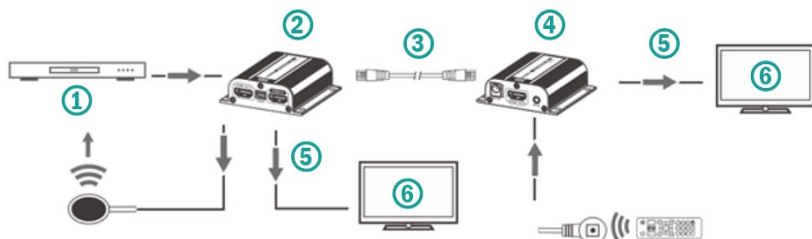

1	DVD	4	HDMI EXTENDER RX
2	HDMI EXTENDER TX	5	HDMI OUT
3	CAT6/6A/7 Cable	6	HDMI display

7. Installation Requirements

1. HDMI source device (computer graphics card, DVD, PS3, HD monitoring equipment etc.).
2. HDMI display device like SDTV, HDTV, and projector with HDMI port.
3. UTP/STP CAT6/6A/7 cable, follow standard IEEE-568B.

8. EDID Setting

Switch Status			EDID information
switch 1	switch 2	switch 3	
0	0	0	720P@60Hz 2.1CH
1	0	0	720P@60Hz 7.1CH
0	1	0	1080i@60Hz 2.1CH
1	1	0	1080i@60Hz 7.1CH
0	0	1	1080P@60Hz 2.1CH
1	0	1	1080P@60Hz 7.1CH

0	1	1	read and save the EDID of the loop-out TV
1	1	1	Default EDID: 1080P 3D 2.1CH

1. Set the source device resolution to “Auto.” Don’t set any specific resolution of the source device.
2. HDMI source device reads the EDID information of the transmitter (TX) and then output the Relative HDMI signal forma.
3. It needs to power on again or reset the transmitter unit after re-setting EDID every time.
4. When connect a TV with loop-out HDMI port of transmitter (TX), it can adjust EDID switch to read and save this TV’s EDID information. When we use this function, it should connect TV with transmitter first, and then power on these devices, so that the EDID will be read and saved successfully. At next time, even though do not connect a TV into the loop-out HDMI Port, the source device will output the saved EDID information last time.

This is a Class A product. In home environment, this product may cause radio interference. In this case, the user may be required to take appropriate measures.

Hereby ASSMANN Electronic GmbH declares that the Declaration of Conformity is part of the shipping content. If the Declaration of Conformity is missing, you can request it by post under the below mentioned manufacturer address.

www.assmann.com

Assmann Electronic GmbH

Auf dem Schüffel 3

58513 Lüdenscheid

Germany

