



4K HDMI Switch, 4x1



Quick Installation Guide

DS-45329

1. Product introduction

The DIGITUS® 4K HDMI Switch, 4x1 offers additional HDMI connections for your output display - 4 signal sources can be connected using just 1 HDMI connection on the screen. The video changeover switch does not require an external power adapter and is supplied with power via the Micro USB cable, e.g. via the source device. Switch conveniently between the signal sources via remote control or on the device itself.

2. Technical Features

1. Switch conveniently between 4 signal sources via remote control or on the device itself
2. Additional HDMI connections for your output device - 4 signal sources via just 1 HDMI connection on the screen
3. Power supply via Micro USB cable - No external power adapter required
4. Supports 4K2K/60Hz (HDR, 4:4:4)
5. Video bandwidth: 18 Gbps
6. Supports High Dynamic Range (HDR)
7. Supports CEC (Consumer Electronics Control)
8. Status LEDs

3. Package content

- 1x HDMI Switch
- 1x Remote control
- 1x Micro USB cable (0.5 m)
- 1x QIG



4. Specification

Input Ports	HDMI x 4
Output Ports	HDMI x 1
Vertical Frequency Range	50/60Hz
Video Amplifier Bandwidth	6.0Gbps/600MHz per channel(18Gbps all channels)
Interlaced(50&60Hz)	480i,576i,1080i
Progressive(50&60Hz)	480p,576p,720p,1080p, 4K@24/25/30/50/60Hz
Limited Warranty	1 Year Parts and Labor
Operating Temperature	0°C to 50°C
Storage Humidity	5% to 80% RH non-condensation
Power Supply	Micro-USB Power cable
Power Consumption (Max)	5W
Switcher Unit Cert	FCC, CE, RoHS
Dimension(L x W x H)	133x59x16 mm
Net Weight	80g
Material	ABS

5. Product overview

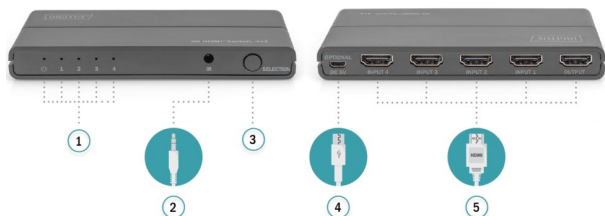

1	Status indicators	4	Micro USB
2	IR-Link	5	HDMI
3	Switch		

6. Connection Diagram



1	Beamer	4	Notebook
2	TV-Streaming Box	5	TV
3	Blu-Ray Player		

7. Troubleshooting

Problems	Causes	Solutions
Power light is off and product is not working	Is the USB power cable properly connected and the HDMI input source is on	Please check if the power adapter is connected properly and switch on the HDMI input source
Screen splash	HDMI cable may not be HDMI 2.0 specification or the cable is too long	Please use the standard HDMI 2.0 cable, the input/output cable length does not exceed 4M 4K/60Hz 4:4:4, 4K@30Hz/1080p can reach 10M to 10M
Remote control can't work properly	Please check the battery seal of the remote control removed clearly and the battery have power or not	Please remove the battery seal clearly firstly, if no working either please changes a new battery to have a try.

Dolby is a trademark of Dolby Laboratories.

The Adopted Trademarks HDMI, HDMI High-Definition Multimedia Interface, and the HDMI Logo are trademarks or registered trademarks of HDMI Licensing Administrator, Inc. in the United States and other countries.

All other trademarks, registered trademarks, or service marks are the property of their respective owners.

Declaration

Hereby Assmann Electronic GmbH, declares that the Declaration of Conformity is part of the shipping content. If the Declaration of Conformity is missing, you can request it by post under the below mentioned manufacturer address.

www.assmann.com

Assmann Electronic GmbH

Auf dem Schüffel 3

58513 Lüdenscheid

Germany

