



# 4K HDMI Splitter, 1x16



**Quick Installation Guide**  
DS-45328

## **1. Introduction**

The DIGITUS® 4K HDMI Splitter, 1x16 distributes an AV signal onto 16 screens in UHD resolution (4K/60Hz) Thanks to the down-scaling function, no screen will remain black if for example a 4K signal needs to be output simultaneously on 4K and Full HD monitors. The splitter also offers the option of EDID management, different modes can be individually configured via the changeover switch.

## **2. Features**

1. Supports 4K2K/60Hz (HDR, 4:4:4)
2. Video bandwidth: 18 Gbps
3. Down-scaling function (4K -> 1080p) - Mixed operation of Full HD + 4K screens possible
4. HDMI 2.0
5. HDCP 2.2 / 1.4
6. Separate on/off switch
7. Status LEDs
8. Supports High Dynamic Range (HDR)
9. EDID management

## 2.1 EDID management Description

Switch down for 0 (↓=LOW)/  Switch up for 1(↑=HIGH)

Mode	DIP Switch status				EDID Setting Description	↓= LOW ↑=HIGH
	1	2	3	4		
Mode1	0	0	0	0	4K@60Hz, 18G, 4:4:4, 2CH AUDIO	
Mode2	1	0	0	0	4K@60Hz, 18G, 4:4:4, 7.1CH AUDIO	
Mode3	0	1	0	0	4K@30Hz, 10.2G, 2CH AUDIO	
Mode4	1	1	0	0	4K@30Hz, 10.2G, 7.1CH AUDIO	
Mode5	0	0	1	0	1080p@60Hz, 2CH AUDIO	
Mode6	1	0	1	0	1080p@60Hz, 7.1CH AUDIO	
Mode7	0	1	1	0	1080i@60Hz, 2CH AUDIO	
Mode8	1	1	1	0	1080i@60Hz, 7.1CH AUDIO	
Mode9	0	0	0	1	1080p@50Hz, 2CH AUDIO	
Mode10	1	0	0	1	1080p@50Hz, 7.1CH AUDIO	
Mode11	0	1	0	1	4Kx2K@30Hz, HDR	
Mode12	1	1	0	1	4Kx2K@60Hz, HDR	
Mode13	0	0	1	1	Copy Once	
Mode14	1	0	1	1	MIX1	
Mode15	0	1	1	1	MIX2	
Mode16	1	1	1	1	MIX3	

## 2.2 Note:

- Copy Once: Read the EDID of the first connected output only
- MIX1: Lowest format of audio/video
- MIX2: Highest format of audio, Compose Downscaler of Video,
- MIX2: Lowest format of audio, Compose Downscaler of Video
- Downscaler: The downscaler function only support the 4K@60Hz 4:4:4 and 4:2:0 (HDR 10) signal downscaler to 1080p signal, or there will not have picture output to the FHD TV and normal picture to 4K HDR supported TV simultaneously.

### 3. Package Contents:

- 1x HDMI splitter
- 1x Power adapter (12V/2A, 1.15 m)
- 1x QIG



### 4. Product Specification

Input Ports	HDMI x1
Output Ports	HDMI x16
Vertical Frequency Range	50/60Hz
Video Amplifier Bandwidth	6Gbps/600MHz per channel (18Gbps all channels)
Interlaced(50&60Hz)	480i,576i,1080i
Progressive(50&60Hz)	480p,576p,720p,1080p,4K@24/25/30/50/60Hz
Limited Warranty	1 Year Parts and Labor
Operating Temperature	0°C to 70°C
Storage Humidity	5% to 90% RH non-condensation
Power Supply	12V/ 2A, 1,15m DC
Power Consumption (Max)	12W
Splitter Unit Cert	FCC, CE, RoHS
Power Supply Cert	FCC, CE, RoHS
Power Adapter Standard	US, EU, UK, AU Standard etc.
Dimension(LxWxH)	257x109x23mm
Net Weight	560g
Material	Metal

## 5. Troubleshooting

<b>Problems</b>	<b>Causes</b>	<b>Solutions</b>
Power light is off and product is not working	Is the power adapter properly connected and the power on/off button is on	Please check if the power adapter is connected properly and switch on the power on/off button
Screen splash	HDMI cable may not be HDMI 2.0 specification or the cable is too long	Please use the standard HDMI 2.0 cable, the input/output cable length does not exceed 5M 4K/60Hz 4:4:4, 4K@30Hz/1080p can reach 10M to 10M
No picture out of some outputs	Maybe these outputs can't support the resolution to show the pictures	Change the EDID mode to the lower resolution mode or select the mode to copy the no picture outputs' TV EDID information to get suitable signal to show
No picture out to a FHD TV when connecting a 4K@60Hz source, and have normal picture to the 4K HDR supported TV at the same time at the downscaler mode	Maybe the downscaler function can't support the input signal, such as 4K@60Hz 4:2:2 HDR signal(Dolby Vision) or when connect one FHD TV with a fixed 4K@60Hz output device	The downscaler function only support the 4K@60Hz 4:4:4 and 4:2:0(HDR 10) signal downscaler to 1080p signal, or there will not have picture output to the FHD TV, the customer need change a supported downscaler signal input.

## 6. Product Overview

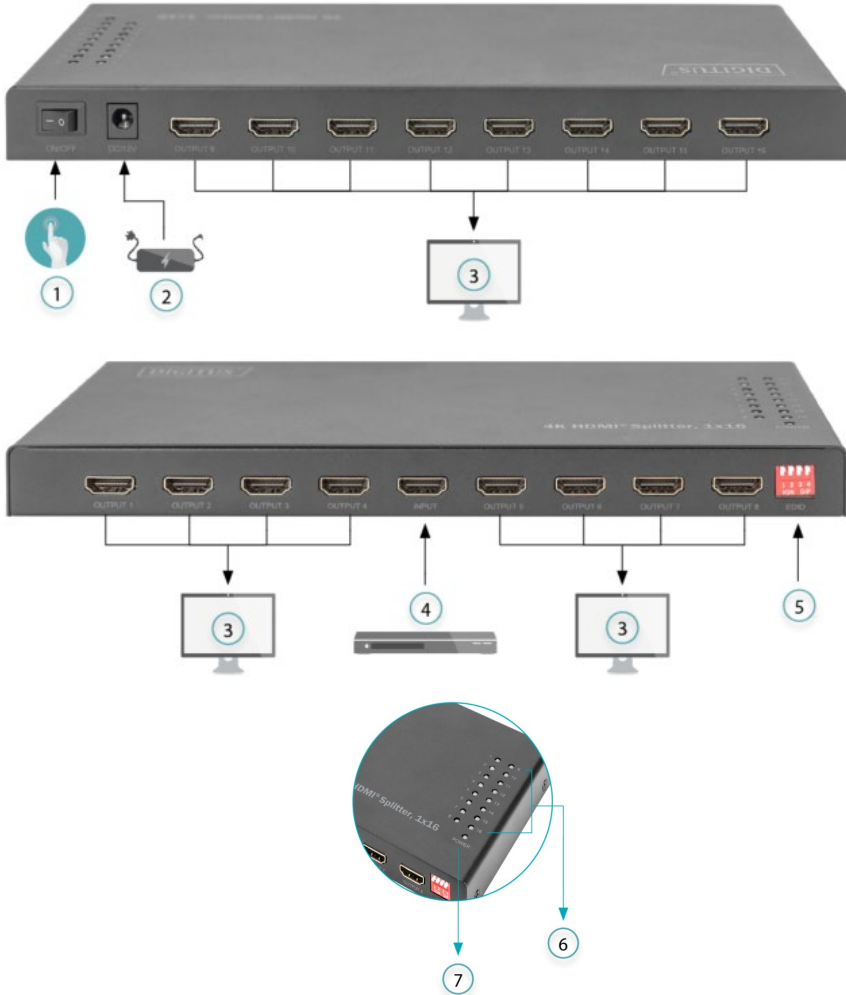

1	ON/OFF: Power on/off Button	
2	DC/12V: DC 12V Input	Power Adapter
3	Output 1-16: HDMI Output 1-16 port	HDMI Display
4	Input: HDMI Input port	HDMI Source
5	EDID: EDID mode Select DIP-Switch	
6	Output 1-16 LED Indicator	
7	POWER: Power LED	

## 7. Connection Diagram

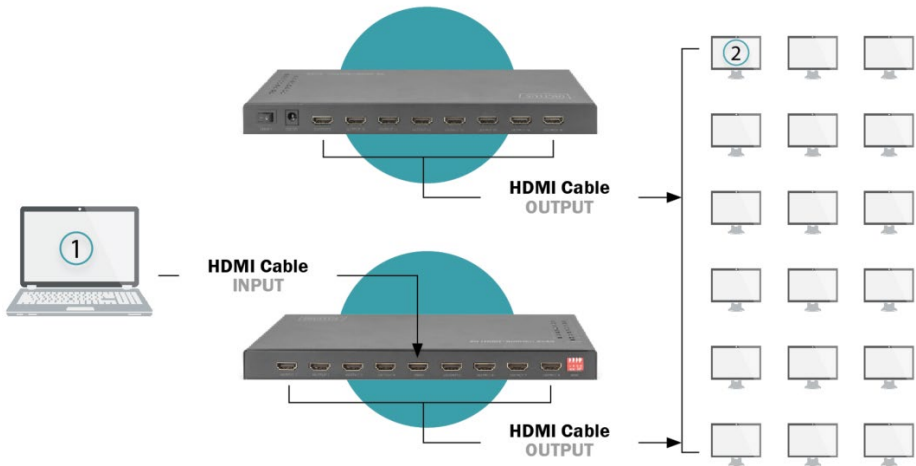

- 1) Notebook
- 2) TV x16

Hereby Assmann Electronic GmbH declares that the Declaration of Conformity is part of the shipping content. If the Declaration of Conformity is missing, you can request it by post under the below mentioned manufacturer address.

**[www.assmann.com](http://www.assmann.com)**

Assmann Electronic GmbH  
Auf dem Schüffel 3  
58513 Lüdenscheid  
Germany

