



## **11-PORT USB-C™ DOCKING STATION WITH SSD ENCLOSURE (M.2)**



**Manual**

DA-70889

## Product Introduction

This DIGITUS® 11-in-1 docking station provides you with a housing for M.2 NGFF SSD memory in addition to the common interfaces such as HDMI®, DisplayPort™, USB or Ethernet. Here you can buffer or store data, e.g. for a presentation.

Extend your system by 3 additional displays with resolutions of up to UHD 4K; e.g. connect your monitor, projector or TV devices. 2 USB-C™ ports enable you to connect your notebook with a power adapter.

This allows you to charge your notebook via Power Delivery. Use the third USB-C™ port to connect additional USB-C™ devices with SuperSpeed (5 Gbps).

4 x USB 3.0 ports give you plenty of connectivity options for peripheral devices: Connect your keyboard, mouse, printer USB sticks or external hard drives.

A Gigabit Ethernet is integrated as well. This allows you to connect to the Internet and also provides you with an audio connection for earphones, speakers or headsets.

Utilize of the full USB-C™ potential and trust in the DIGITUS® 11-in-1 docking station as well as its M.2 NGFF memory installation option.

# Structure Diagram

## Front:

1. M.2 SATA 3.0 NGFF SSD Enclosure
2. LED indicator
3. USB-A (data + downstream charge)
4. USB-C (data + downstream charge)
5. 3.5mm Audio & Microphone
6. USB-A (data + downstream charge)

## Back:

1. USB-A (data 5Gbps)
2. USB-A (data 5Gbps)
3. RJ45 Gigabit Ethernet
4. DP
5. DC Port - Power Input for docking
6. USB-C input (connect to host)
7. HDMI 1
8. HDMI 2
9. USB-C PD 3.0

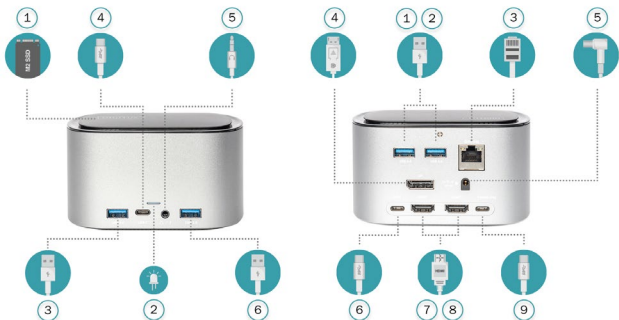

# Connection

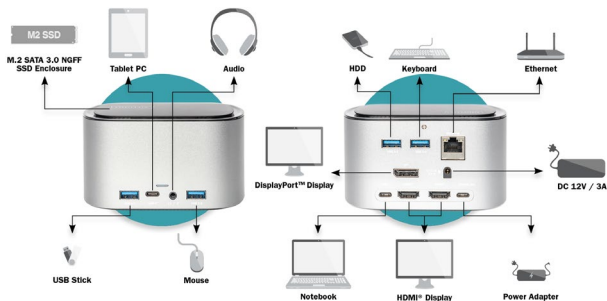

# Features

## Front:

1. M.2 SATA 3.0 NGFF SSD Enclosure Transfer speed: 5Gbps
2. Exclusively designed for SATA-based M.2/ NGFF (B key & B+M Key) SSD ONLY
3. Support SSD lengths including: 80 mm (2280), 60 mm (2260), 42 mm (2242) and 30 mm (2230) M.2 NGFF SATA SSD up to 2TB.

**NOTE: It doesn't support M.2 NVMe PCI-E SSDs, M.2 PCIe AHCI SSDs, or other M.2 non-SATA devices.**

4. LED indicator
5. USB-A 3.0 (data + downstream charge): 5Gbps, 5V/1.5A @7.5W
6. USB-C 3.0 (data + downstream charge): 5Gbps, 5V/3A @15W
7. 3.5mm Audio & Microphone
8. USB-A 3.0 (data + downstream charge): 5Gbps, 5V/1.5A @7.5W

## Back:

1. USB-A 3.0: 5Gbps, 5V/0.9A @4.5W
2. USB-A 3.0: 5Gbps, 5V/0.9A @4.5W
3. RJ45 Gigabit Ethernet: 1000Mbps
4. DP: 4K x 2K @60Hz / 3840x2160
5. DC: 36W(12V/3A) power adapter for docking's power supply

6. USB-C: connect to host
7. HDMI 1: 4Kx2K 30Hz / 3840x2160 max
8. HDMI 2: 4Kx2K 60Hz / 3840x2160  
(work separately while source is DP 1.4 )  
4Kx2K 30Hz / 3840x2160  
(work separately while source is DP 1.2 )
9. USB-C PD3.0: Upstream charging the source devices such as Laptop/Notebook, charging limited to 87-96W for safety and affected by different firmware. Support 100W power adapter

### In the box

- 1 x Product
- 1 x 36W (12V/3A) power adapter
- 1 x USB-C to USB-C cable
- 1 x Screw set (include a screwdriver)
- 1 x User manual

### M.2 NGFF SATA 3.0 SSD Enclosure:

1. Exclusively designed for SATA-based M.2/ NGFF, insert the correct M.2 SSD properly. (B key & B+M Key) SSD, do not support M key M.2 SSDs.

**NOTE: It doesn't support M.2 NVMe PCI-E SSDs**

2. It is normal that the case heats up since the high-speed M.2 SSD drives generate a lot of heat while working.
3. Most of the new SSD need to be initialized, partitioned and formatted.

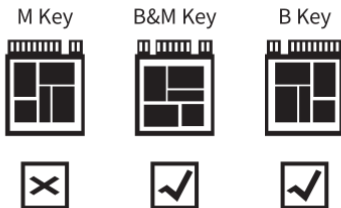

## Warm Reminder

1. Please make sure the USB-C port of your Smartphone/Tablet/Laptop supports the DP feature before purchase, or your PC will not output any contents.
2. 4Kx2K@60Hz video display, need your computer support DisplayPort (DP) v1.4 (HBR3).
3. Please update Mac OS of your MacBook to Catalina (10.15.1) or above version for better compatibility.

## FAQ

### a. Why is there no video output?

1. Please check the connection is good.
2. Please use standard HDMI or VGA cable.
3. Please make sure select the correct input source for your HDMI and DP monitor.

### b. Why is there no audio output from HDMI port?

1. Please make sure that there is audio output function on the monitor.
2. Please set the external monitor as default audio output device.

### c. Can I connect my Apple SuperDrive to the dock?

1. No, some devices such as the Apple SuperDrive look for Apple-specific signaling and will not work when connected through any USB hub.

### d. My docking station not charging my laptop?

1. Verify if your system supports PD over USB-C and also identify which port has this functionality if multiple USB-C ports are available.  
Please note that some systems that charge over USB-C/Thunderbolt 3 may not support charging from universal docks and may only charge from approved chargers and devices from the system manufacturer.

Hereby Assmann Electronic GmbH, declares that the Declaration of Conformity is part of the shipping content. If the Declaration of Conformity is missing, you can request it by post under the below mentioned manufacturer address.

[www.assmann.com](http://www.assmann.com)

Assmann Electronic GmbH  
Auf dem Schüffel 3  
58513 Lüdenscheid  
Germany

