



ednet Smart Home

Quick Installation Guide

84295 • 84297

Safety Precautions

EN

- Only use the ednet smart home devices within the specified temperature range for:
Sensors & Actors: 0 ~ 40°C
- When not in use, store the product in a clean and dry place in temperatures between 0°C and 40°C
- Do not cover ednet.smart home products
- Do not let the indoor devices including camera and sensors come into contact with liquids (except outdoor cameras with IP66 protective cover)
- ednet Smart Home does not replace adult supervision. Safeguard the health of your children, family members or pets by regularly looking after them
- Ensure that the indoor devices are only used inside. These devices are not intended for outdoor use and can be damaged. In this case use the specified outdoor models.
- Protect the sensors and actors from electrical and other HF devices generating interferences (microwaves, mobile phones, etc.)
- Keep camera, network cable and power cord outside the reach of children, since these components can be dangerous
- Only use the supplied power adapter.
- Never try to repair ednet smart home system by yourself. Repair and maintenance work must be carried out by specialists.
- In case of problems contact our customer service.

Personal Information

- Read and accept the privacy policy for using the ednet smart home systems under <http://ednet-europe.eu/en/ednet-smart-home/datenschutzerklaerung-fuer-das-kameraportal-und-apps/>
- Select a password with a high degree of safety for your ednet smart home account to protect it from unauthorized access.
- The password should contain at least 8 characters; we recommend case-sensitive letters and alphanumeric characters.
- Furthermore, the standard password of the camera should be changed to avoid unauthorized access here as well.

Live stream, push notification and further services are available via a cloud server. Despite backup solutions, system stability and bandwidth management the uninterrupted availability of the system cannot be guaranteed.

What's in the box

84295

- 1 x Indoor Siren
- 1 x Quick Installation Guide

84297

- 1 x Outdoor Siren
- 1 x Quick Installation Guide

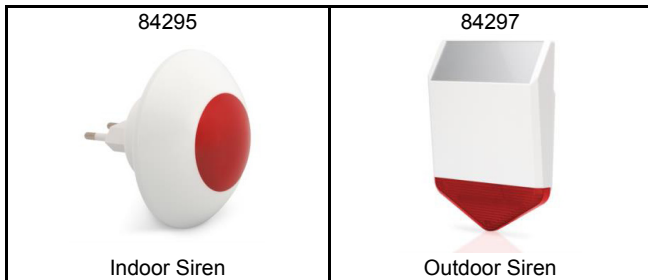

Thank you for choosing ednet Smart Home, which can be up-and-running quick and easy without complicated network settings.

Preparation

84295 and 84297 are the additional Sirens (actors) that you can add onto your ednet.home Starter Kit (84299) or the IP camera gateway (84302) as accessories.

Before starting, please make sure the following items are prepared beforehand:

1. A Starter Kit (84299) or an IP Camera gateway (84302).
2. ednet.home App downloaded to your Android or iOS device.

Actors Connections

Indoor Siren

Please insert the Indoor Siren to your Power Socket with AC 100-240V to power on and charge the internal battery in the Siren.

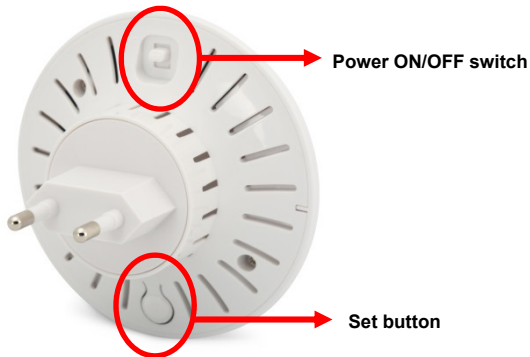

Power ON/OFF switch

- ON: means the Siren would consumes the internal battery energy when the Siren is removed from the AC power socket.
- OFF: means the Siren is switched OFF completely when Siren is removed from the AC power socket.

* Please note that when Siren is plug into the AC power socket, it is always ON and charging its battery no matter if the switch is set ON or OFF.

Set Button:

- Short press: every short press can be used to adjust different volume levels (including mute) and also the alert light mode.
- Long press: press the “Set” button and hold it for more than 5 seconds, this would trigger the Siren to enter “Learning” mode.

Power Status LED indicator:

- Green LED: battery is fully charged
- Red LED: battery is under charging

Factory Default:

- Long press the “Set” button for more than 15 seconds to reset.

Outdoor Siren

Please power ON the Outdoor Siren with a Micro USB cable to the 5Vdc USB charger. This would also charge its internal battery.

Back Side Illustration

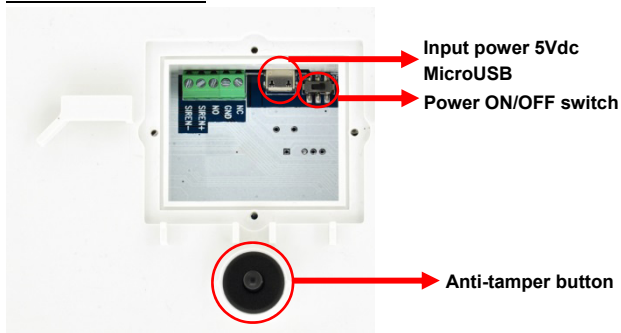

Power ON/OFF switch

- ON: means the Siren would consumes the internal battery energy when the Siren is removed from the AC power socket.
- OFF: means the Siren is switched OFF completely when Siren is removed from the AC power socket.

* Please note that when Siren is powered by external power, it is always ON and charging its battery no matter if the switch is set ON or OFF.

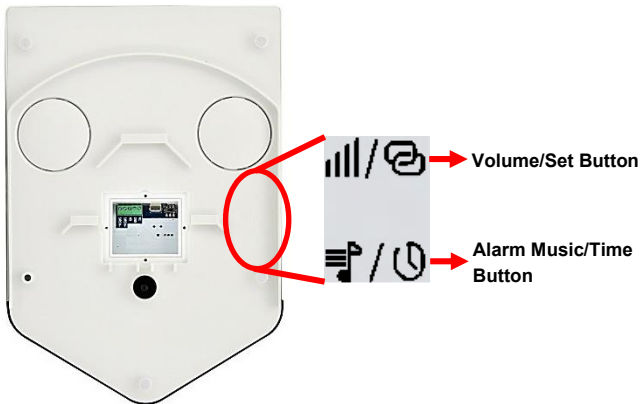

Volume / Set Button: 

- Short press: every short press can be used to adjust different volume levels (including mute) and also the alert light mode.
- Long press: press the “Set” button and hold it for more than 5 seconds, this would trigger the Siren to enter “Learning” mode.

Alarm Music / Time Button: 

- Short press: every short press can be used to change different alarm music types (total 4 types).
- Long press: press the “Alarm Time” button and hold it for more than 5 seconds, this would allow you to enter the “Alarm time change” setting:

Then each short press on the “Set” button would change the alarm-time.

- 1x Beep: alarm time for 10 seconds
- 2x Beeps: alarm time for 1 minute
- 3x Beeps: alarm time for 2 minutes
- 4x Beeps: alarm time for 5 minutes

To complete the alarm time setting, please short press the “Alarm time” button to exit the setting.

Anti-tamper Function:

When the anti-tamper switch is triggered, the Siren would be turned on automatically.

Add Actors to the Gateway

ednet Smart Home system provides Sensors (Transmitters) and Actors (Receivers).

Transmitter sensors are Motion sensors and Contact sensors.

Receiver devices are Siren, Power plug and others which can be activated in relation with the event triggered by Transmitter sensors such as motion sensor.

So let's try to setup the Receiver device:

After pressing the "Sensor/Actor" icon on the camera live-view page, you will enter the sensor/actor list. **(1)**

Please press the "+" sign on the top right corner to add the Siren (84295 and 84297) as the Receiver device.



Please select the "type" as "Siren" to add on the App side. **(2)**

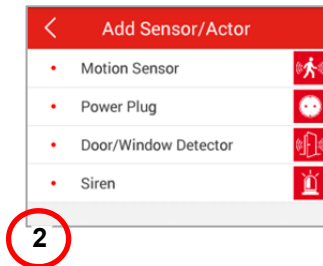

Please give a Name to the Siren. Then press the “Learn Sensor/Actor” button. **(3)**

Before pressing “Learn Sensor/Actor” button on the App side, please make sure your Siren is powered and entered “learning” mode already.

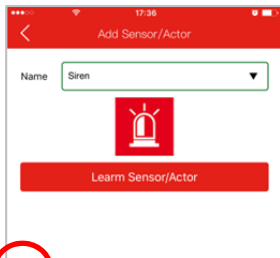

Please long press the “Set” button on the Siren (84295 or 84297) for 5 seconds until the LED is light-ON at the Siren.

Then press “Yes” on the App to start the “learning”. **(4)**



Please press “Yes” if you see the LED blinking at the Siren **(5)**.

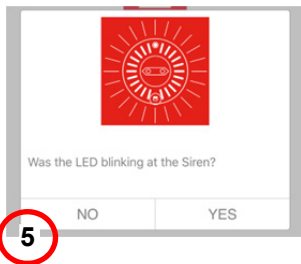

Please press “OK” to finish the learning process on the App side (6).

In parallel, please also press the “Set” button once on the backside of the Siren to exit and complete the learning process.

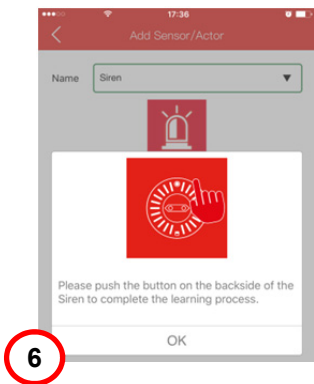

Trademarks

ednet is a registered trademark of ASSMANN Electronic GmbH. Apple, Apple App Store is registered trademarks of Apple Inc. Android, Google, Google play are registered trademarks of Google Inc. AVM Fritz!Box is a registered trademark of AVM Computersysteme Vertriebs GMBH. Telekom Speedport is a registered trademark of Deutsche Telekom AG.

Note:

All other trademarks not listed here, are the property of their respective owners. Trademarks or trade names mentioned in this manual are used to describe the operating steps and do not imply that they are freely available. In any case they are the property of the respective holder of the rights.

84295 Technical descriptions:

Frequency Range	433.92 MHz (Rx)
Transmit Power	--
Hardware Version	KR-J009-D
Software Version	V12

84297 Technical descriptions:

Frequency Range	433.92 MHz (Duty cycle<10%)
Transmit Power	7.71dBm ERP
Hardware Version	KR-SJ1-119-A
Software Version	V1.4

Hereby Assmann Electronic GmbH, declares that the Declaration of Conformity is part of the shipping content. If the Declaration of Conformity is missing, you can request it by post under the below mentioned manufacturer address.

www.assmann.com

Assmann Electronic GmbH

Auf dem Schüffel 3

58513 Lüdenscheid

Germany

