

ednet.



Sonar II LED Bluetooth[®] Speaker

User Manual

33047

Important Safety Instructions

- Keep speaker away from water and other liquids.
- Keep speaker away from any source of heat.
- Adjust the volume to a suitable level so as to avoid damaging your hearing, or the unit itself.
- If you do not use the speaker for a long time, please charge and discharge at least once a month, in order to prevent the lithium battery from damages caused by excessive consumption.

Features

1. Five Multi-colored LED Themes

Full spectrum light themes matching with your music

2. Bluetooth® Music and Mobile Hands-free Function

Bluetooth® 4.0 stereo music playing, support mobile hands-free function.

3. NFC (Near Field Communication)

One touch easy pairing with your NFC Smartphone

4. Aux In

Enable the device work as the external speaker by connecting to the audio source of computer, mobile, PSP/MP3/MP4 etc.

5. USB Sound card & Card reader

USB Sound Card, card reader and charging functions can be achieved via the same USB cable

Technical Data

Voltage: DC 5V

Impedance: 4Ω

Output: 2x 3.5W

AUX IN Jack: 3.5mm

Net Weight: 444g

Size: 184.7mm x 73.3mm x 81.0mm

Package Contents

- LED Bluetooth® Speaker x1
- Micro USB Cable x1
- User Manual x1
- 3.5mm audio cable x1

Slot and Keys

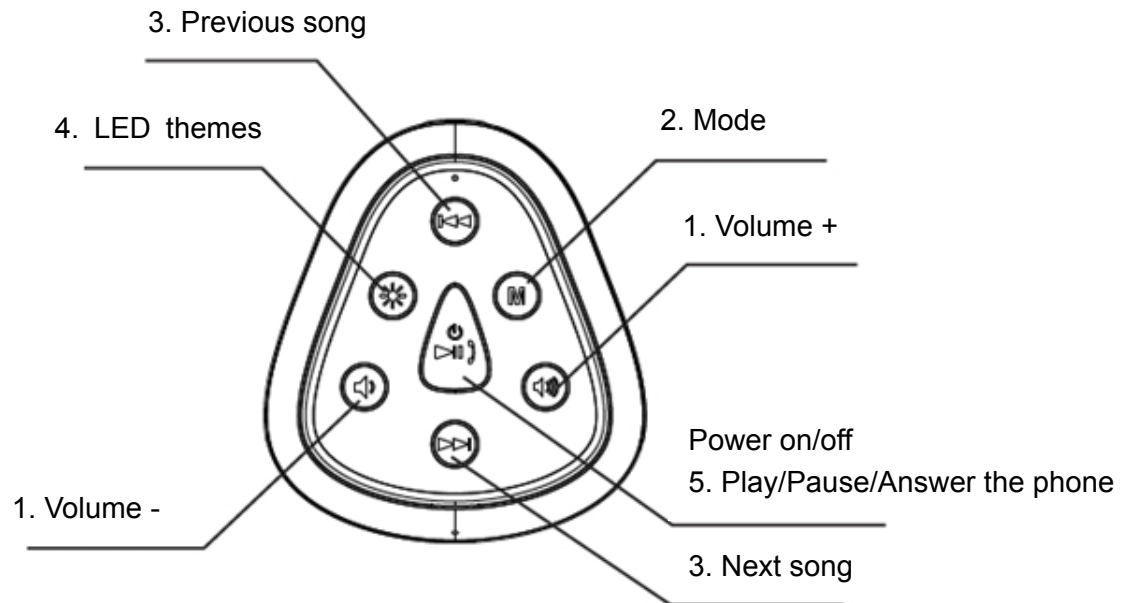

Micro USB Interface

AUX Jack

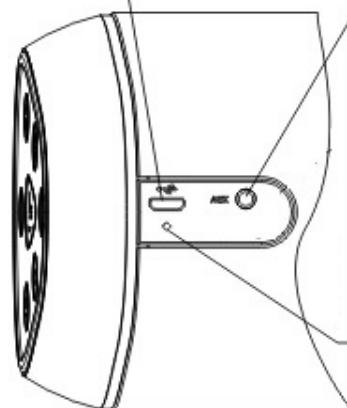

Quick Start

1. /



Short press the  /  buttons to decrease/increase the volume gradually.

Long press the  /  buttons to decrease/increase the volume continuously.

2. **M**

Short press the **M** button to switch the mode of Bluetooth®/AUX In

3. /



Under music playing mode, short press the  /  buttons to switch to the previous/next song.

Long press the  /  buttons for previous/next folder.

4.

Short press to switch the LED themes

5.

Long press the  button and hold for 2 seconds to power on the speaker, the Working Indicator Light will be blue. Long press the  button to power off the speaker. Short press the  button to pause/play/mute/answer the phone/end up the phone

6. + /

Pressing the light and the volume buttons simultaneously, you can choose the level of illumination: no lighting, level 1, level 2 and level 3.

Instructions

1. Bluetooth®

(1) Bluetooth® Paired

Press the **M** button to enter the Bluetooth® mode. Then turn on the Bluetooth® function of your mobile or other devices for pairing Ednet LED Light Bluetooth speaker. The “**Sonar II**” will be found, please connect it. (The speaker will voice “Device paired” when connected successfully).

(2) NFC Function

(It requires the mobile has the NFC function and the speaker is in Bluetooth® mode)

Turn on the mobile’s NFC function and make the mobile touch the speaker’s NFC area. The mobile will remind you to pair with the Bluetooth® device. Choose yes to complete the pairing.

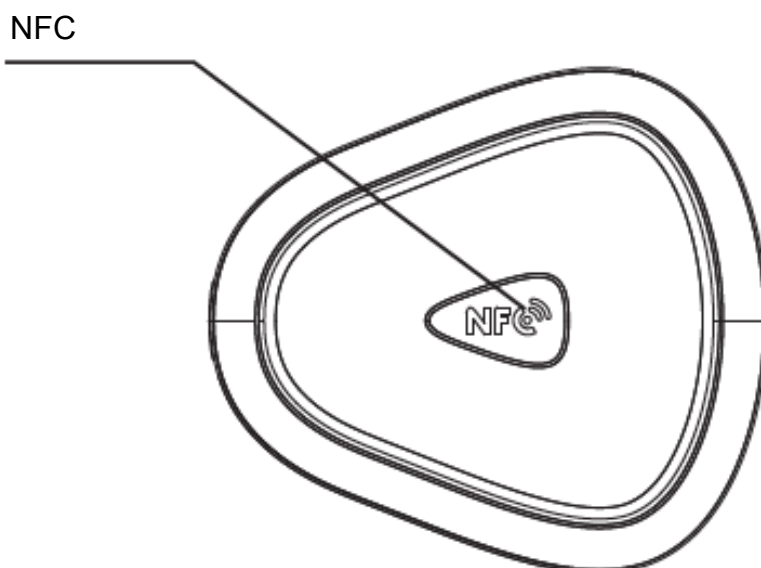



(3) Bluetooth® Music

Please turn on the mobile or other devices’ music player, and speaker will play the selected music.

(4) Mobile Hands-free

Under pairing, using phone to call, it can enter the Hands-free status.

When a mobile call comes in, short press the  button to pick up the phone, re-press the  button to end up the call. Press the  button twice and speaker will re-dial the last telephone number.

2. LED Themes

Short press 🌞 to switch the LED themes, there are five different LED themes.



Club

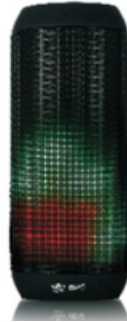

Equalize

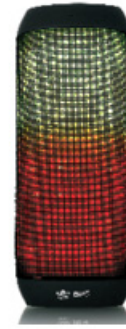

Groove



Rainbow

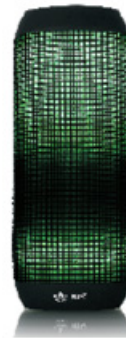

Meteor

Please note: The Club and Equalize themes only display when music playing

3. Gravity sensor

In Club and Equalize themes, the speaker supports gravity sensor.

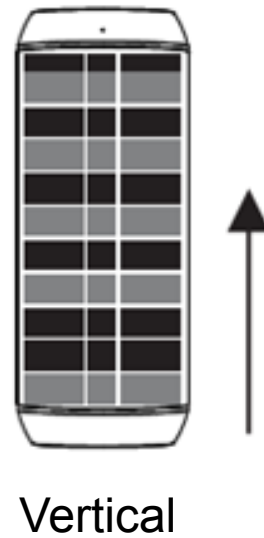
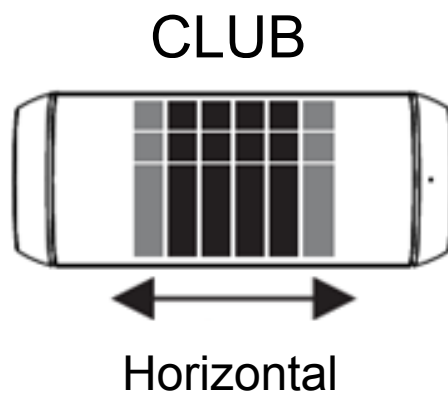

EQUALIZE

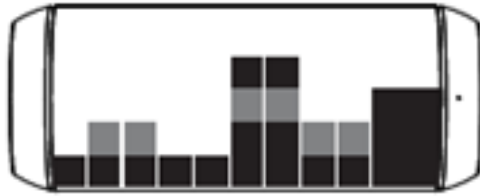

Horizontal

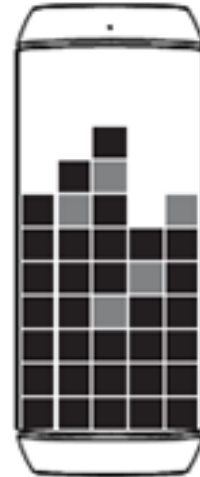

Vertical

4. Aux In

Use the 3.5mm audio cable included to connect the speaker to an audio source (PC, MP3/MP4, mobile phone). Short press the **M** button to enter “**AUX IN**” mode (the speaker will voice “Aux in” mode). The speaker will play the music from the audio source.

Please note: Low battery will affect the music sound quality, please charge the speaker by adaptor (5V 1A) immediately.

5. Charging

The speaker uses a built-in lithium battery. You can use the USB cable included to connect the speaker to the computer or a branded good quality 5V/1000mA adaptor to charge the battery. When charging, the LED indicator is orange, and after finishing the charging, the LED indicator will turn blue.

Please note: Low battery will make the indicator light flash quickly. Please charge immediately.

App Download

If you have an Apple® iOS device, then you will find our "ednet.audio" App in the Apple App Store®.

For smartphones and tablets running on Google Android OS you can find our "ednet.audio" App in the Google™ Play Store.

In the search field of the respective App Stores® enter "ednet" or "ednet.audio".

Apple App Store®



Google™ Play

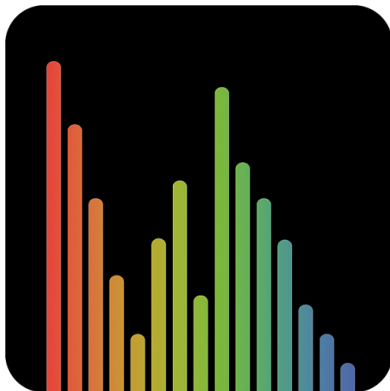
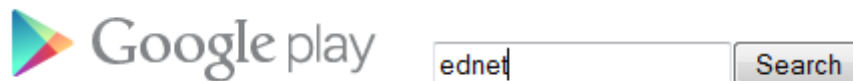

In the Search results the "ednet.audio" App will be marked with this symbol. Then install the App on your mobile device.

APP Manual



When you connect the **ednet** Sonar II LED Bluetooth® Speaker with your mobile device via Bluetooth®, the APP will work as below:

Settings:

How to connect your device and play the music via Bluetooth®

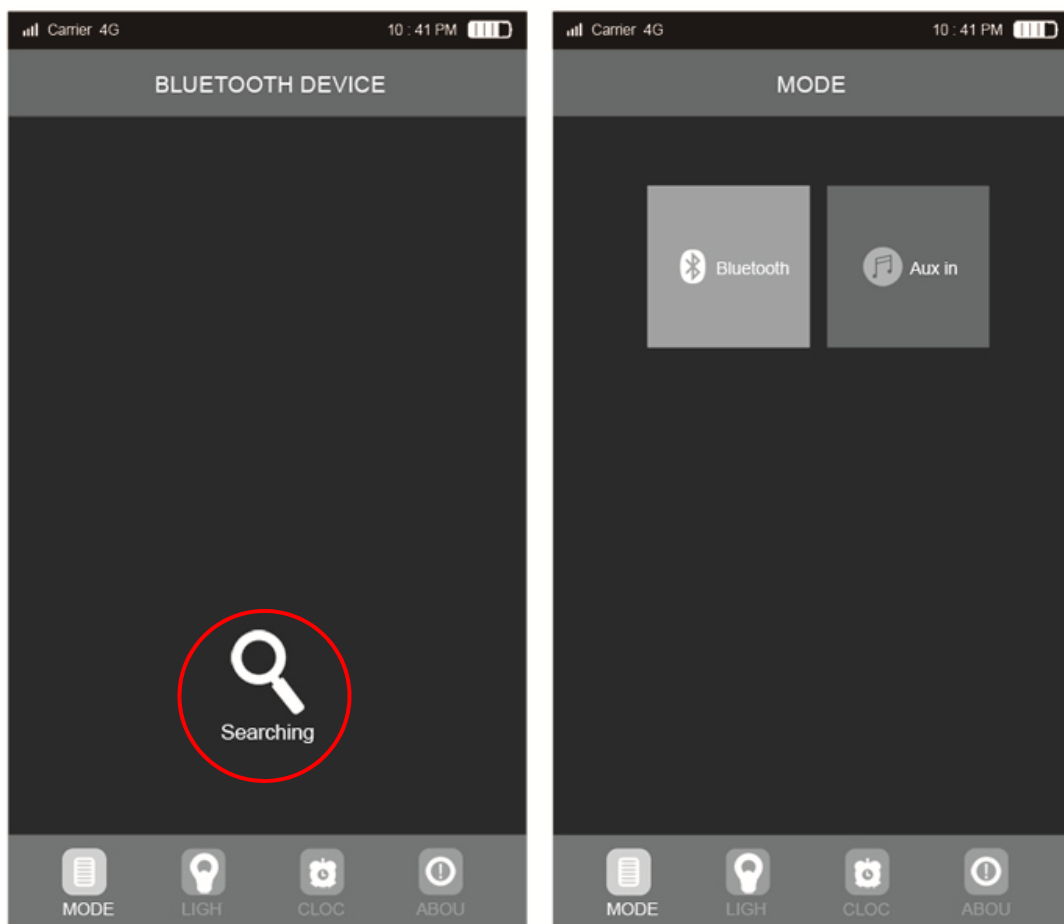

Open “ednet.audio” APP, click “Searching” on the page of “BLUETOOTH® DEVICE” In the list, choose the model name “Sonar II”.

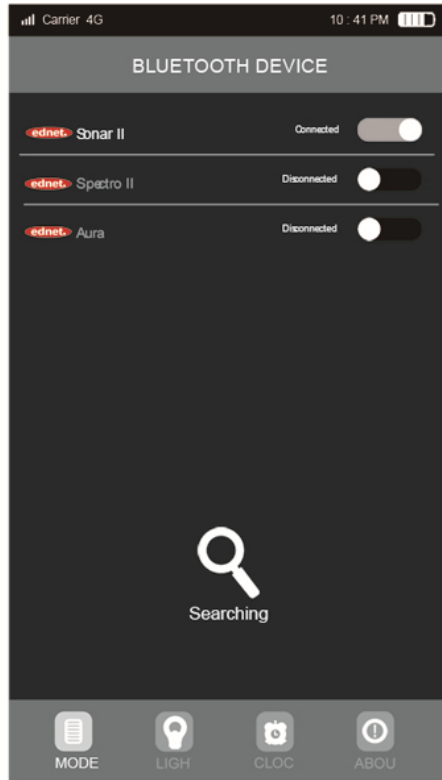

After successful connection, enter the Bluetooth® playing mode, there will be a list of songs in the MP3 format. So click on one of the songs to play, or click the button “Previous”/“Next” to choose another song.

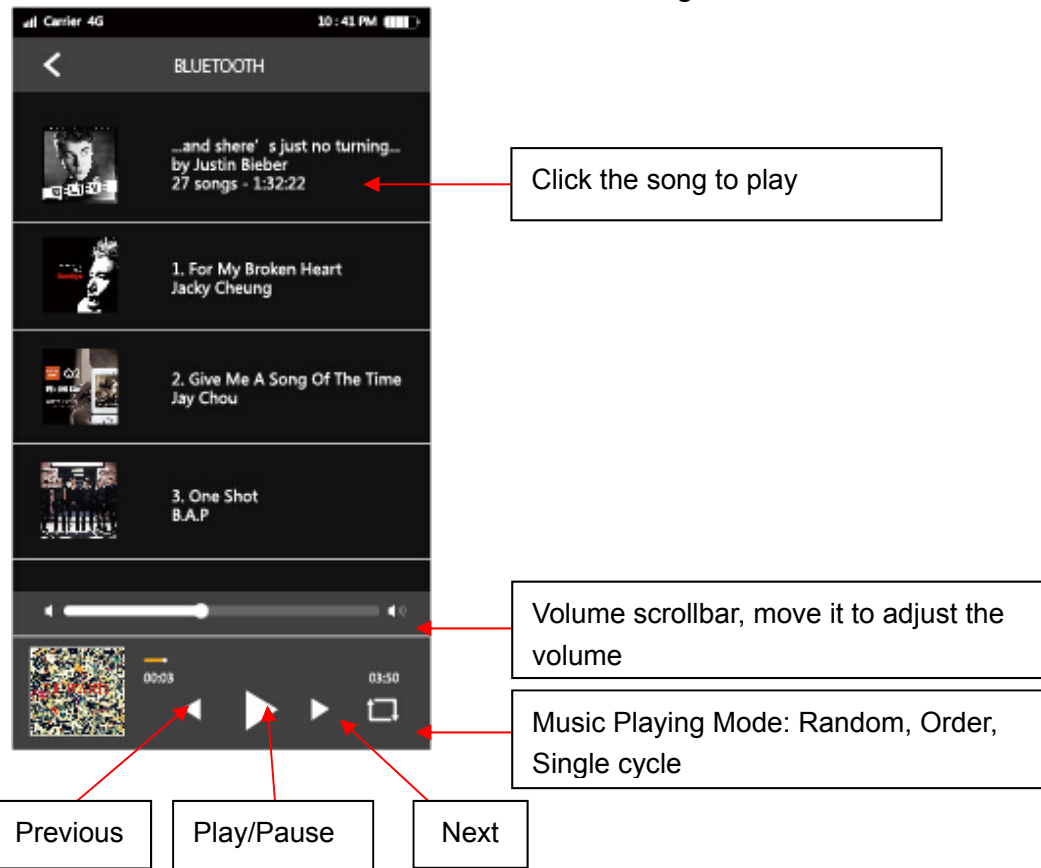

How to control the multi-color full spectrum themes

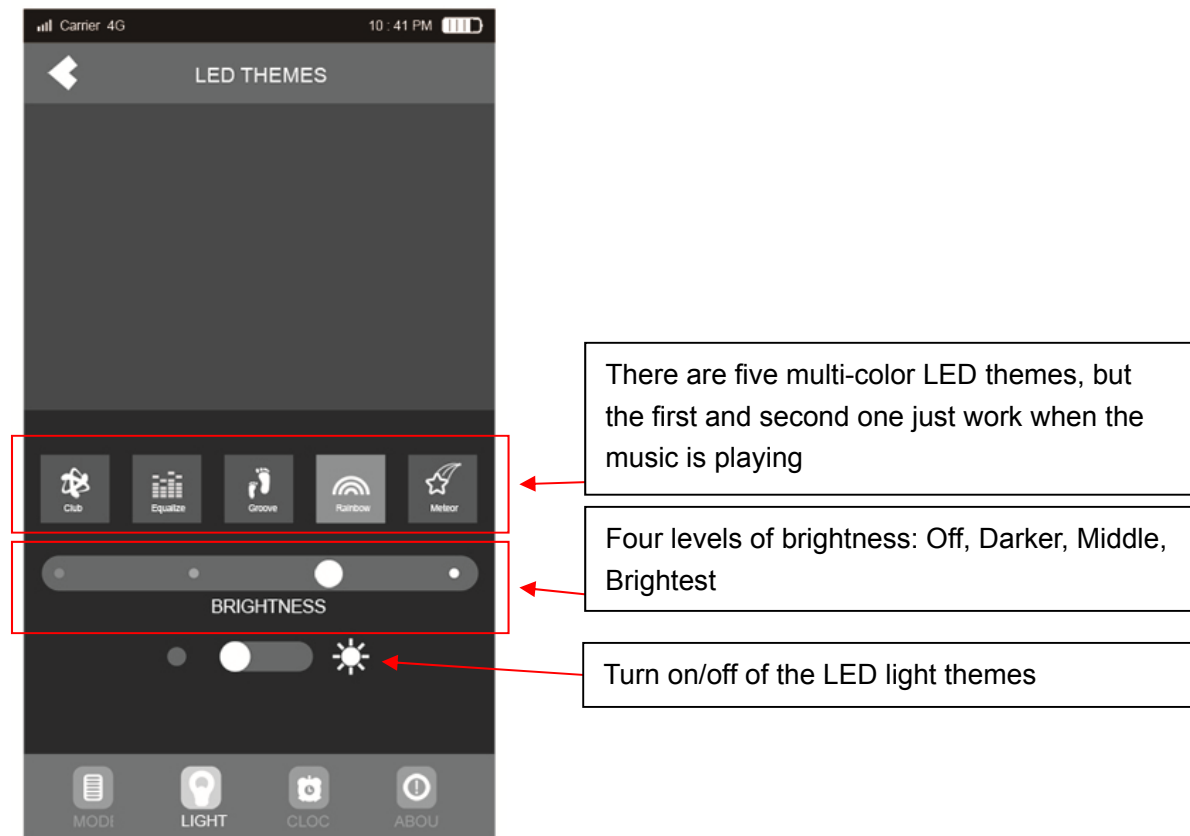

How to set the alarm

Click the time on the page of "ALARM" to set the time.

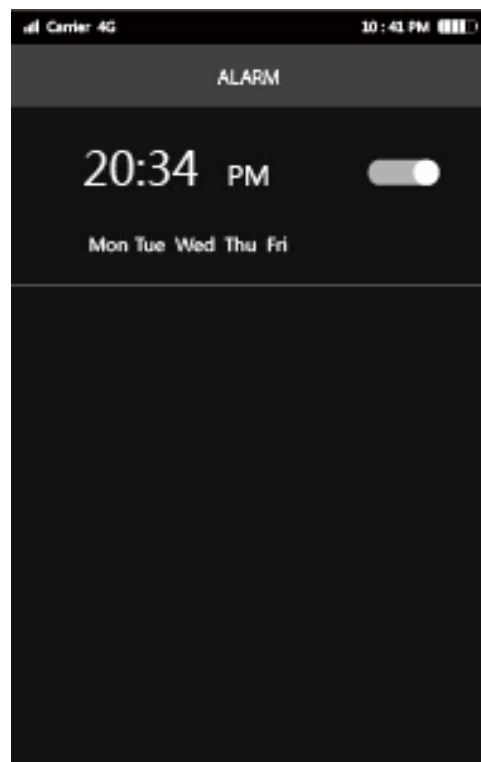

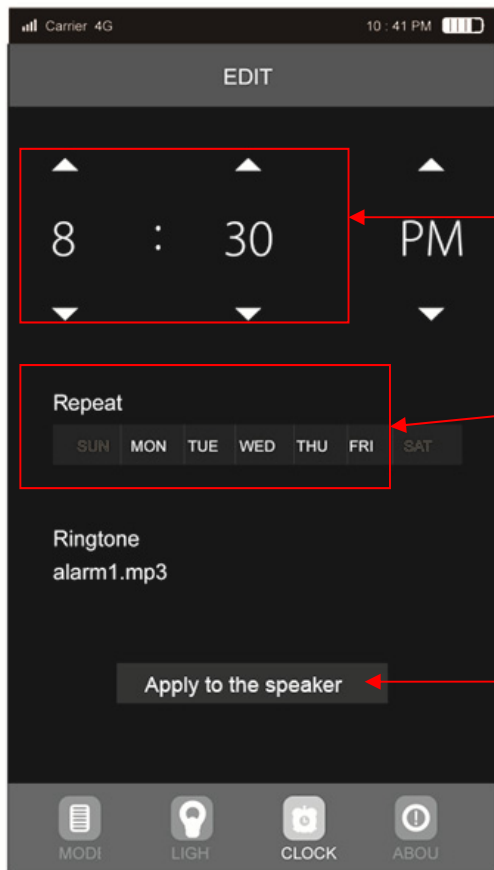

Set the time of alarm

Set the repeat times of alarm

Confirm the alarm to the speaker

Troubleshooting

1. What should I do if the speaker cannot pair with the Bluetooth® device and play music accordingly?

Please check the specification/the manual of the Bluetooth® device (your mobile or computer), and check if the device can support the A2DP stereo audio transmission. If yes, please turn on the A2DP stereo mode.

2. What should I do if the PC USB function could not work?

- (1) Connect the speaker to the computer via the USB cable included, and enter the PC USB mode. And then play the video/audio from the computer.
- (2) If it could not work, it may be the problem that the sound card of the speaker is incompatible with the computer. Please try to click the device manager - click the Voice video and games controller - right click the USB Audio device - click the uninstall. Then please switch the speaker to PC USB mode again. The computer will automatically update the USB sound card drive to achieve the compatibility.

Please note: The USB sound card function only apply to: Windows XP/Windows vista Windows 7/windows 8.

Hereby ASSMANN Electronic GmbH, declares that this device is in compliance with the requirements of Directive 2014/53/EU and the Directive 2011/65/EU for RoHS compliance. The complete declaration of conformity can be requested by post under the below mentioned manufacturer address.

Warning:

This device is a class B product. This equipment may cause some radio interference in living environment. In this case, the user can be requested to undertake appropriate measures to prevent interference.

www.assmann.com
Assmann Electronic GmbH
Auf dem Schüffel 3
58513 Lüdenscheid
Germany

