



8K HDMI Switch, 5x1



Quick Installation Guide
DS-55334

1. Introduction

The DIGITUS® 8K HDMI Switch, 5x1 offers additional HDMI connections for your output display - 5 signal sources can be connected using just 1 HDMI connection on the screen. The video changeover switch is supplied with power via the USB-C cable, e.g. via the source device or a USB charging adapter. Switch conveniently between the signal sources via remote control, on the device itself or via automatic recognition. Perfectly suited for use with wall installation of TV - only a HDMI cable is required to connect the sources.

2. Main Features

- Switch conveniently between 5 signal sources via remote control, on the device itself or via automatic recognition
- Additional HDMI connections for your output device - 5 signal sources via just 1 HDMI connection/cable on the screen
- Power supply via USB-C cable (included)
- Max. resolution: 8K/60Hz (4:4:4)
- Video bandwidth: 48 Gbps
- Supports High Dynamic Range (HDR)
- Supports HDCP 2.3
- Supports Consumer Electronics Control
- Supports Deep Color (36-bit)
- HDMI 2.1

3. Package Content

- 1x HDMI Switch
- 1x Remote control (2x AAA batteries, not included)
- 1x USB-C cable (1,0 m)
- 1x QIG

4. Technical Features

Specs	Description
Video Input	5x HDMI
Video Output	1x HDMI
Vertical Frequency Range	50/60/100/120/240 Hz
Video Bandwidth	12Gbps / 1200MHz per channel, 48Gbps all channels
Interlaced Resolutions	480i, 576i, 1080i
Progressive Resolutions	480p, 576p, 720p, 1080p, 4K@24/30Hz, 4K@50/60/120Hz, 8K@24/30/50/60Hz
Operating Temperature	0°C to 70°C
Storage Humidity	5% to 90% RH non-condensation
Power Supply	USB-C (Cable)
Power Consumption (Max)	5W
Dimension (LxWxH)	160 x 62 x 14.2mm
Net Weight	215 g
Housing	Metal

5. Overview

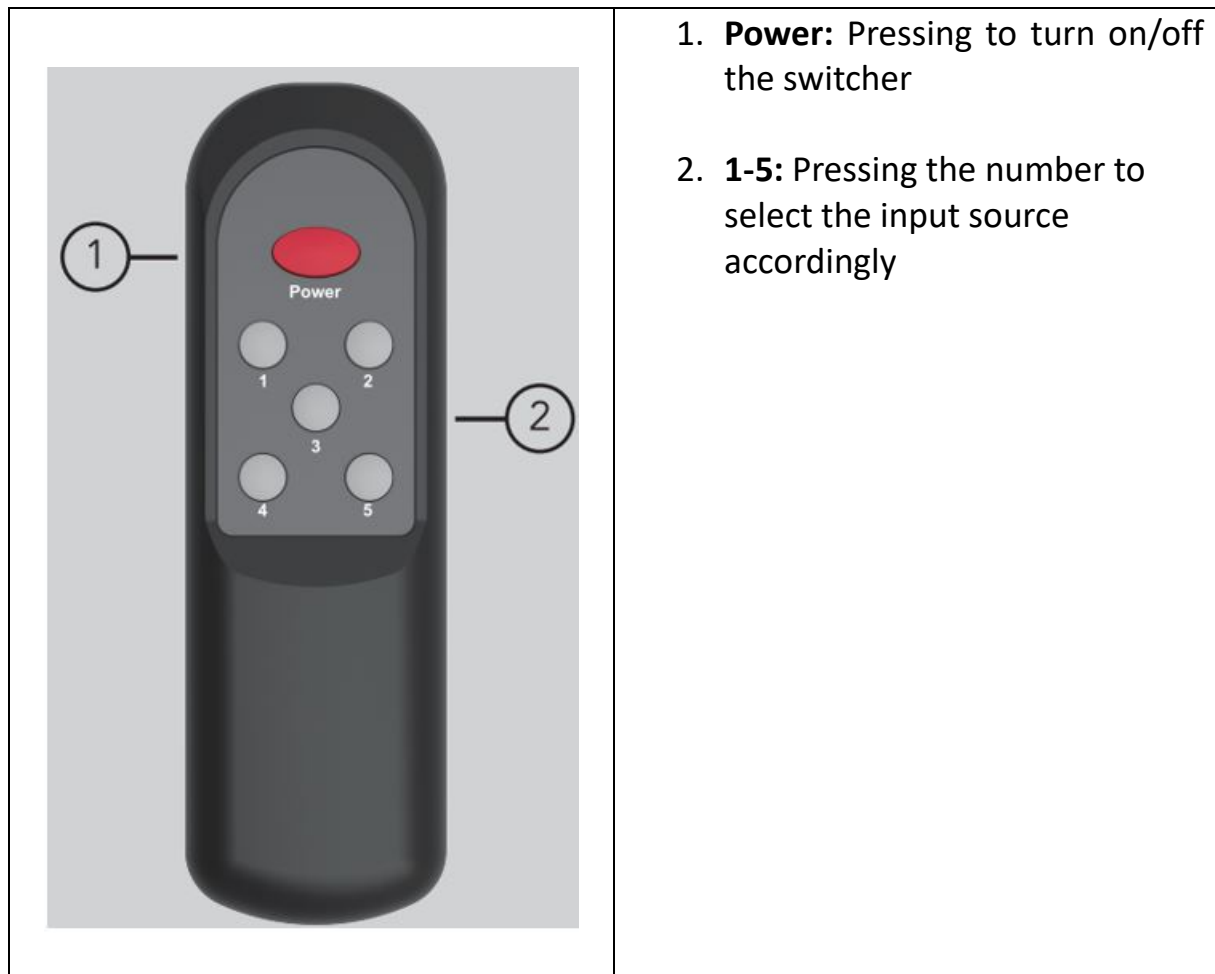

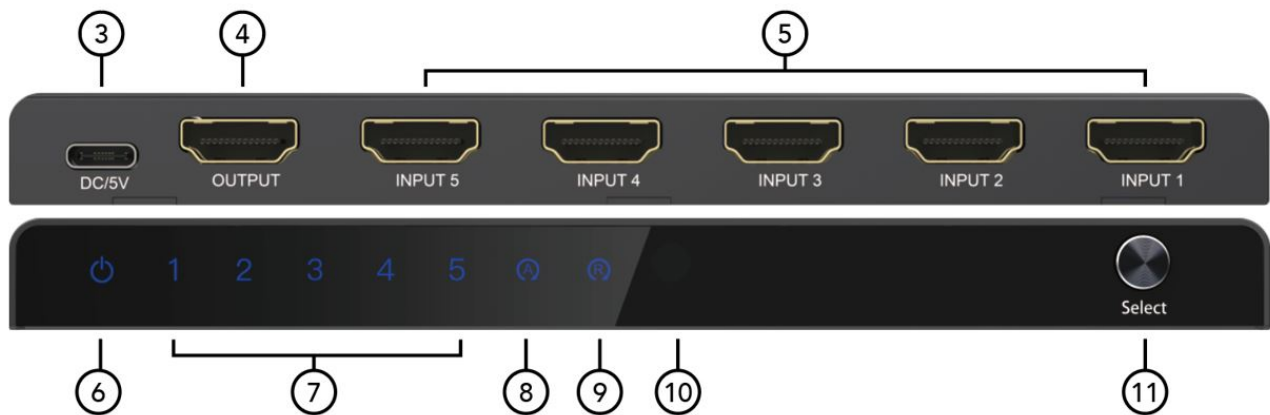

<p>3. DC/5V: DC 5V Input via USB-C port</p> <p>4. OUTPUT: HDMI Output</p> <p>5. INPUT 1-5: HDMI Input</p> <p>6. Power LED Indicator:</p> <ul style="list-style-type: none"> - Red LED indicates: “Standby mode” - Blue LED indicates: “Working mode” - No LED indicates: “No Power supply connected” <p>7. 1/2/3/4/5: Input Port 1/2/3/4/5 LED Indicators</p> <ul style="list-style-type: none"> - Blue LED indicates: “Active input signal” - No LED indicates: “No input signal” <p>8. Auto Mode LED Indicator:</p> <ul style="list-style-type: none"> - ON: is in Automatic Switching mode - OFF: is in Manual Switching mode 	<p>9. IR Mode LED Indicator:</p> <ul style="list-style-type: none"> - ON: IR receiver mode activated - OFF: IR function de-activated <p>10. IR: IR signal receiver port</p> <p>11. Select button:</p> <ul style="list-style-type: none"> - Short press to change the input channel; and long press the selector button till 3 seconds to change the manual switching or automatic switching mode - Auto mode LED indicator: on for automatic switching mode and off for manual switching mode - Turn on/off the IR receiver mode: if long press the selector button for 6 seconds to turn on/off the IR receiver mode
--	---

6. Connection Diagram



7. Troubleshooting

The power indicator is off and the product is not working. How can I fix this?

A: Please check the following points first:

1. make sure the HDMI input device of your device is properly connected and turn it on.
2. check that the HDMI port is correctly selected and connected
3. check the power supply of the switcher

My screen flickers when I use the switcher. What is the cause of this?

A: This may be caused by one or more of the following:

1. make sure the HDMI cable and the switcher are properly connected.

2. make sure that the HDMI cable is an Ultra High Speed HDM 2.1 cable and the max. length is 1.5 m each for input and output at 8K/60Hz (4:4:4) | at 4K/60Hz the max. length is 4 m each for input and output.
3. switch to another connection to test the display.

**The automatic switching function of the switcher does not work normally.
What could be the cause?**

A: If the automatic switching function is to work normally, the connected HDMI source must be plugged in again or switched off completely so that it can be switched on.

Disclaimer

Hereby ASSMANN Electronic GmbH declares that the Declaration of Conformity is part of the shipping content. If the Declaration of Conformity is missing, you can request it by post under the below mentioned manufacturer address.

www.assmann.com

Assmann Electronic GmbH

Auf dem Schüffel 3

58513 Lüdenscheid

Germany

