



## USB KVM Switch



DS-11403

## USB KVM switch with audio, 2-Port



DS-12402

## USB KVM switch with audio, 4-Port

### Manual

DS-11403 (2-Port) • DS-12402 (4-Port)

## NOTE

This equipment has been tested and found to comply with the limits for a class B digital device, pursuant to Part 15 of the FCC rules. These limits are designed to provide reasonable protection against harmful interference in a residential installation. This equipment generates, uses and can radiate radio frequency energy and, if not installed and used in accordance with the instruction manual, it may cause harmful interference to radio communications. However, there is no guarantee that interference will not occur in a particular installation. If this equipment does cause harmful interference to radio or television reception, which can be determined by turning the equipment off and on, the user is encouraged to try to correct the interference by one or more of the measures listed below:

- Reorient or relocate the receiving antenna.
- Increase the separation between the equipment and receiver.
- Connect the equipment into an outlet on a circuit different from that to which the receiver is connected.
- Consult the dealer or an experienced radio/television technician for help.



## PACKING LIST

The complete DS-11403 (2 ports) / DS-12402 (4 ports) USB package consists of:

- USB KVM switch
- KVM connection cable 2 pcs (DS-11403) or 4 pcs (DS-12402)
- User Manual

Please check to make sure that all the components are present and that nothing was damaged in shipping. If you encounter a problem, contact your dealer.

Read this manual thoroughly and follow the installation and operation procedure carefully to prevent any damage to the unit, and/or any of the devices that connect to it.

## Content

|                      |   |
|----------------------|---|
| OVERVIEW .....       | 3 |
| FEATURES .....       | 3 |
| INSTALLATION .....   | 4 |
| OPERATION .....      | 5 |
| Panel Control .....  | 5 |
| Hot Key Control..... | 5 |
| SPECIFICATIONS.....  | 6 |
| SAFE GUIDE.....      | 7 |

## OVERVIEW

KVM switches can save money and space in multiple computer systems. Users do not need to purchase a separate keyboard, monitor and mouse for each computer. They allow users to access and control up to 2 (DS-11403) or 4 (DS-12402) computers via a single USB keyboard, USB mouse, and VGA monitor. The setup is easy and there is no software to configure. Simply plug and play.

KVM DS-11403 / DS-12402 have audio support. It controls 2 (DS-11403) / 4 (DS-12402) computers via a single keyboard, mouse, monitor and speaker. It can switch the video, audio, keyboard and mouse data connection among computers. It helps users to set up the multiple computer system at a low cost.

## FEATURES

- Operating different computers with one keyboard, mouse and monitor.
- Easy KVM operation with push-buttons and hot keys.
- Compatible with wireless keyboard and mouse.
- Supporting high video resolution up to 1920x1080
- Supporting both speaker and microphone audio.
- Compatible with all operating systems.
- LEDs display port status automatically.
- Power supply by USB. No Power adapter needed.
- Supporting Auto Scan mode.
- No software configuration.

## INSTALLATION

All the connectors are on the rear panel. The rear panel is shown as following:

DS-11403

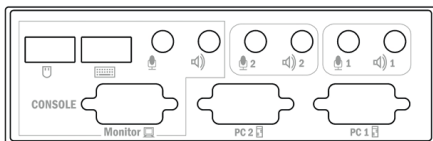

DS-12402

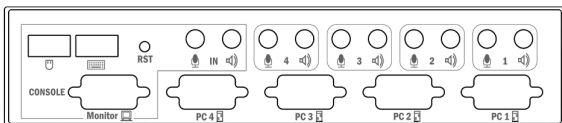

Mouse interface



Keyboard interface



Monitor interface



Speaker interface



Host signal interface



Microphone interfacep

Before installing, please make sure that all the devices are power off, and then do the following:

1. Plug the mouse, keyboard, monitor and audio into their respective port on the console section.  
(For the Wireless keyboard + mouse USB adaptor, please connect with keyboard USB console port)
2. Plug the KVM cable connectors of the host into their respective port on the console panel on the KVM switch.
3. Plug the other ends of the KVM cable connectors into the computer, with the VGA connector connected to the video card output interface and the audio connector connected to the sound card Input / Output interface.
4. Repeat step 2 and 3 until all KVM cables are connected.
5. Power on computers. You can access and control the computer after you switch to the port attached to it.

## OPERATION

### Panel Control

KVM switching and port status indication can be done on the front panel. The front panel is shown as following:

DS-11403

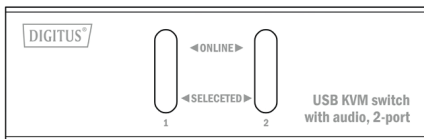

DS-12402

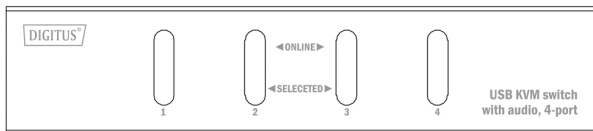

Buttons on panel are selection buttons. Just press one button and then you can select the corresponding port. Each button has upper and lower LEDs indicating on line and selected statuses. The upper indicates the on line status. It lights if the corresponding computer is on line. The lower indicates the selected status. Since there is only one port selected at one time, the only one LED lights to show that the corresponding computer is selected.

In order to prevent uncertainty caused by unplugging mouse or keyboard on the console panel. You can press KVM button [1] and [2] at the same time to reset the system. (DS-12402 only)

### Hot Key Control

It provides several particular switching hot keys for convenience.

#### Hotkey Switching

- Rapidly press left [Ctrl] to increase port number by 1.
- Rapidly press Right [Ctrl] to decrease port number by 1.

#### Auto Scanning

- Rapidly press [Scroll lock] twice and press [Enter] to start port scanning function. It automatically increases 1 port number in every 5 seconds interval until pressing [space bar].

## SPECIFICATIONS

|                         |                              |                   |                   |
|-------------------------|------------------------------|-------------------|-------------------|
| Type                    | DS-11403                     | DS-12402          |                   |
| Computer connections    | 2                            | 4                 |                   |
| Computer port selection | Front panel switches/Hot key |                   |                   |
| Console connector       | Keyboard                     | 1 x USB female    |                   |
|                         | Mouse                        | 1 x USB female    |                   |
|                         | Video                        | 1 x HDB-15 female |                   |
|                         | Speaker                      | 1 x 3.5mm (Green) |                   |
|                         | Mic.                         | 1 x 3.5mm (Pink)  |                   |
| Computer connection     | Keyboard                     |                   |                   |
|                         | Mouse                        | 2 x HDB-15 Female | 4 x HDB-15 Female |
|                         | Video                        |                   |                   |
|                         | Speaker                      | 1 x 3.5mm (green) | 4 x 3.5mm (green) |
|                         | Mic.                         | 1 x 3.5mm (pink)  | 4 x 3.5mm (pink)  |
| LEDs                    | On line                      | 2 (Red)           | 4 (Red)           |
|                         | Selected                     | 2 (Green)         | 4 (Green)         |
| Video resolution        | 1920x1080                    |                   |                   |
| Power                   | DC5V, 0.4W                   |                   |                   |
| Auto Scan interval      | 5 seconds                    |                   |                   |
| Operating temperature   | -10°C~50°C                   |                   |                   |
| Storage temperature     | -20°C~60°C                   |                   |                   |
| Housing                 | Metal, Black                 |                   |                   |
| Weight                  | 530g                         | 760g              |                   |
| Dimensions (L x W x H ) | 133 x 94 x 42 mm             | 203 x 111 x 42 mm |                   |

## SAFE GUIDE

- Please follow the directions below when installing, using and maintaining the device in order to guarantee the normal operation of the device.
- When installing and operating the device, please make sure all devices are powered on, and then do other operations after it is initialized.
- Keep well ventilated during operation to prevent overheating.
- Do not operate the device in high humidity environments to prevent short circuits.
- Please do not open the device without permission of professionals.

Note: If wrongly installed or improperly used in the living area, the device can cause interference in radios and other electronic devices. Appropriate use is when the device, as far as feasible, is operated with shielded connection cables (with network products in addition to category 5 shielded cables and higher). The device has been tested and falls within the limits of class B computing equipment according to the requirements of EN 55022.

Warning: This device conforms with test category B - it can cause radio interference in the living area; in this case the operator may demand that appropriate measures are implemented and arise for this reason. Declaration of conformity: The device fulfills the EMV requirements according to EN 55022 for ITE and EN 55024. Devices with external or integrated power supply furthermore fulfill the requirements of EN 61000-3-2 and EN 61000-3-3. In this way, the fundamental protection requirements of the EMV-2004/108/EC guideline are fulfilled. The CE conformity has been proven. The pertinent declarations are deposited with the manufacturer.

**www.assmann.com**  
ASSMANN Electronic GmbH  
Auf dem Schüffel 3  
58513 Lüdenscheid  
Germany

