



# USB-C™ DOCKING STATION, 8 PORT



**Quick Installation Guide**

DA-70887

## Product introduction

This is a high-end ABS multifunctional USB-C™ hub, which can extend the USB-C™ port on your laptop. More ports can be extended including HDMI, Ethernet, USB 3.0 and SD & TF Card Reader and USB-C™ female PD charge.

## Structure Diagram



USB Type-C™  
with Power Delivery  
Function



HDMI®



3x USB 3.0



RJ45



SD card



microSD card



USB Type-C™

## Features

### 1. HDMI

4Kx2K 30 Hz (3840 x 2160), downward compatible with 1080P, 1080I, 720P

### 2. SD/TF Card Reader

Read: 50 – 104 MB/s;

Write: 30 – 40 MB/s;

affected by card's quality

### 3. USB 3.0

5 Gb/s data transfer, downward

compatible with USB 2.0;

power supply up to 4.5 W Max.

### 4. PD 3.0

Support 100 W power in, charging limited

to 87-96 W for safety, affected by different firmware.

### 5. Ethernet: 1000 M

# Connection

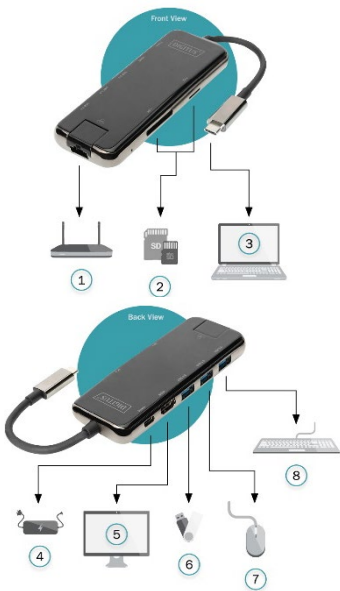

1	Router	5	HDMI® Display
2	Memory cards	6	USB Stick
3	Notebook	7	Mouse
4	Power supply	8	Keyboard

**Note:** For Video output, USB-C™ source devices must support video output.

## F&Q

- ❖ Why is there no video output?
  - Please check the connection is good
  - Please use standard HDMI cable
  
- ❖ Why is there no audio output from HDMI port?
  - Please make sure that there is audio output function on monitor.
  - Please set the external monitor as default audio output device.

Hereby Assmann Electronic GmbH, declares that the Declaration of Conformity is part of the shipping content. If the Declaration of Conformity is missing, you can request it by post under the below mentioned manufacturer address.

**[www.assmann.com](http://www.assmann.com)**

Assmann Electronic GmbH

Auf dem Schüffel 3

58513 Lüdenscheid

Germany

